

Service Parts for TMC Electric Toilet Model 99907

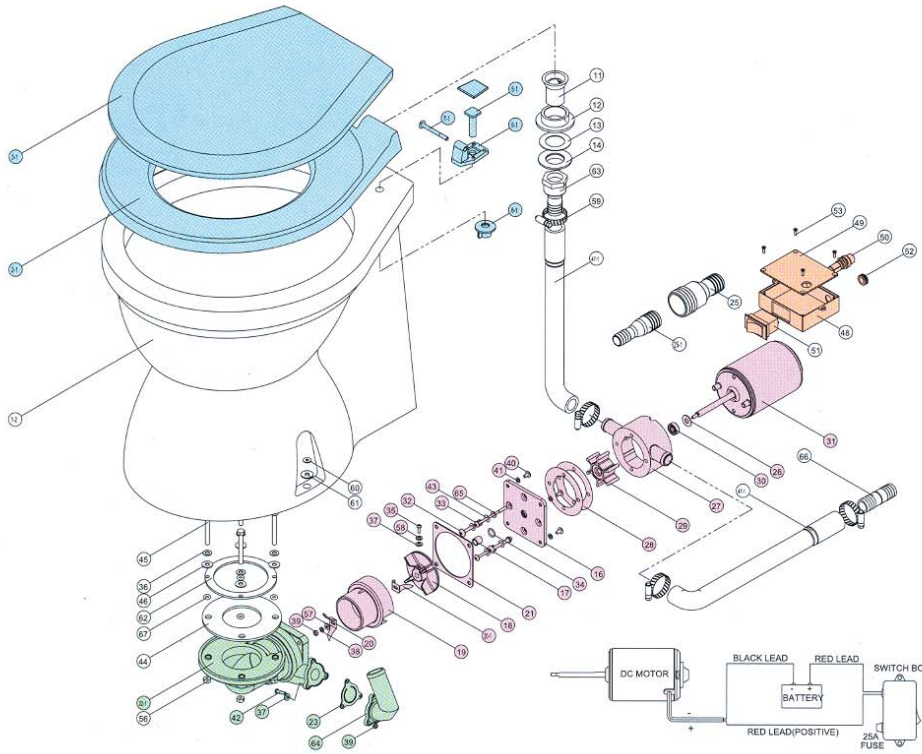

Note: part * supplied to both pump unit & base unit.

TMC-00041

DELUX TYPE, PLASTIC SEAT AND COVER FOR MARINE TOILET
INCLUDE PARTS NO. 2-1, 3-1, 5-1, 6-1, 7-1, 8-1

TMC-00036

PUMP UNIT DC 12V FOR ELECTRIC TOILET
INCLUDE PARTS ET16-21, 26-35, 37-41, 43, 57, 58 & 65

TMC-00037

PUMP UNIT DC 24V FOR ELECTRIC TOILET
INCLUDE PARTS ET16-21, 26-35, 37-41, 43, 57, 58 & 65

TMC-00045

BASE UNIT FOR ELECTRIC TOILET
INCLUDE PARTS ET22-1, 23, 37, 39, 42 & 64

TMC-00046

CONVERSION KITS FOR ELECTRIC TOILET SEAT & COVER (W/O #1-10)
AVAILABLE IN DC 12V & DC 24V

TMC-99902S

SWITCH BOX ASSEMBLY SUITABLE FOR ELECTRIC TOILET
INCLUDES PARTS ET 48-53

| KEY | DESCRIPTION | Q'TY |
|-------|----------------------|------|
| ET1-2 | Closestool Body | 1 |
| 2-1 | Seat Cushion | 1 |
| 3-1 | Closestool Cover | 1 |
| 4 | | |
| 5-1 | Set Bolt | 2 |
| 6-1 | Coupligh+Cover | 2 |
| 7-1 | Union Screw | 2 |
| 8-1 | Wing Nut | 2 |
| 9 | | |
| 10 | | |
| 11 | Joint | 1 |
| 12 | Joint Packing | 1 |
| 13 | Flat Washer | 1 |
| 14 | Joint Nut | 1 |
| 15 | | 1 |
| 16 | Wearplate | 1 * |
| 17 | Sleeve Kit | 1 |
| 18 | Centrifugal Impeller | 1 * |
| 19 | Macerator Housing | 1 |
| 20 | Razor Blade/upper | 1 |
| 20-1 | Razor Blade/lower | 1 |
| 21 | Gasket | 1 |
| 22-1 | Base | 1 |

| KEY | DESCRIPTION | Q'TY |
|------|---|------|
| 23 | Flapper Valve | 1 |
| 24 | | |
| 25 | Adaptor $\phi 17\text{mm}(5/8")-\phi 25\text{mm}(1")$ | 1 |
| 25-1 | Adaptor $\phi 25\text{mm}(1")-\phi 39\text{mm}(1-1/2")$ | 1 |
| 26 | Slinger | 1 |
| 27 | Body | 1 |
| 28 | Gasket | 1 |
| 29 | Flexible Impeller | 1 |
| 30 | Seal | 1 |
| 31 | Motor | 1 |
| 32 | Screw | 1 |
| 33 | Screw | 1 |
| 34 | O Ring | 1 |
| 35 | Set Screw | 1 |
| 36 | Flat Washer | 4 |
| 37 | Flat Washer | 4 |
| 38 | Spring Washer | 1 |
| 39 | Hexagon Nut | 4 |
| 40 | Screw | 4 |
| 41 | Spring Washer | 4 |
| 42 | Screw | 3 |
| 43 | Flat Washer | 4 |
| 44 | Base Packing | 1 |

| KEY | DESCRIPTION | Q'TY |
|------|--------------------|------|
| 45 | Hexagon Bolt | 4 |
| 46 | Plastic Washer | 2 |
| 47-1 | Hose | 1 |
| 48 | Switch Box | 1 |
| 49 | Cover | 1 |
| 50 | Fuse & Fuse Holder | 1 |
| 51 | Switch Box | 1 |
| 52 | Gasket | 1 |
| 53 | Tapping Screw | 4 |
| 55 | | |
| 56 | Hexagon Nut | 4 |
| 57 | Flat Washer | 1 |
| 58 | Spring Washer | 1 |
| 59 | Clamp | 4 |
| 60 | Flat Washer | 2 |
| 61 | | |
| 62 | Anchor Plate | 1 |
| 63 | Pipe Joint | 1 |
| 64 | Pipe Bender | 1 |
| 65 | Rubber Washer | 4 |
| 66 | Inner Pipe Joint | 1 |
| 67 | O Ring | 4 |